

# Технические характеристики

## По вопросам продаж и поддержки обращайтесь:

Алматы (7273)495-231  
Ангарск (3955)60-70-56  
Архангельск (8182)63-90-72  
Астрахань (8512)99-46-04  
Барнаул (3852)73-04-60  
Белгород (4722)40-23-64  
Благовещенск (4162)22-76-07  
Брянск (4832)59-03-52  
Владивосток (423)249-28-31  
Владикавказ (8672)28-90-48  
Владимир (4922)49-43-18  
Волгоград (844)278-03-48  
Вологда (8172)26-41-59  
Воронеж (473)204-51-73  
Екатеринбург (343)384-55-89  
Иваново (4932)77-34-06  
Ижевск (3412)26-03-58  
Иркутск (395)279-98-46  
Казань (843)206-01-48  
Россия +7(495)268-04-70

Калининград (4012)72-03-81  
Калуга (4842)92-23-67  
Кемерово (3842)65-04-62  
Киров (8332)68-02-04  
Коломна (4966)23-41-49  
Кострома (4942)77-07-48  
Краснодар (861)203-40-90  
Красноярск (391)204-63-61  
Курск (4712)77-13-04  
Курган (3522)50-90-47  
Липецк (4742)52-20-81  
Магнитогорск (3519)55-03-13  
Москва (495)268-04-70  
Мурманск (8152)59-64-93  
Набережные Челны (8552)20-53-41  
Нижний Новгород (831)429-08-12  
Новокузнецк (3843)20-46-81  
Ноябрьск (3496)41-32-12  
Новосибирск (383)227-86-73  
Киргизия +996(312)-96-26-47

Омск (3812)21-46-40  
Орел (4862)44-53-42  
Оренбург (3532)37-68-04  
Пенза (8412)22-31-16  
Петрозаводск (8142)55-98-37  
Псков (8112)59-10-37  
Пермь (342)205-81-47  
Ростов-на-Дону (863)308-18-15  
Рязань (4912)46-61-64  
Самара (846)206-03-16  
Саранск (8342)22-96-24  
Санкт-Петербург (812)309-46-40  
Саратов (845)249-38-78  
Севастополь (8692)22-31-93  
Симферополь (3652)67-13-56  
Смоленск (4812)29-41-54  
Сочи (862)225-72-31  
Ставрополь (8652)20-65-13  
Сургут (3462)77-98-35  
Казахстан +7(7172)727-132

Сыктывкар (8212)25-95-17  
Тамбов (4752)50-40-97  
Тверь (4822)63-31-35  
Тольятти (8482)63-91-07  
Томск (3822)98-41-53  
Тула (4872)33-79-87  
Тюмень (3452)66-21-18  
Ульяновск (8422)24-23-59  
Улан-Удэ (3012)59-97-51  
Уфа (347)229-48-12  
Хабаровск (4212)92-98-04  
Чебоксары (8352)28-53-07  
Челябинск (351)202-03-61  
Череповец (8202)49-02-64  
Чита (3022)38-34-83  
Якутск (4112)23-90-97  
Ярославль (4852)69-52-93

# Comfort Twin Electric Breast Pump

Double Breast expression

Let mothers express more milk in less time. With this portable twin electric breast pump both breasts can be expressed simultaneously. Three user controlled vacuum settings offer personalized comfort for a steady supply of milk.



# Features



## 3 simple expression settings

When switched on, the pump automatically starts in a gentle stimulation mode to help trigger let down. Then the mother can choose between three 'one touch' pressure settings to make the milk flow most effectively for her. The system's comfort features have been clinically proven to lead to more milk expression.



## Reduced expression time

The Philips Avent twin electric breast pump is the perfect time saver for busy mothers as both breasts can be expressed simultaneously. And simultaneous expressing may boost a mother's ability to produce breast milk<sup>3</sup>.



## Easy-to-use, even on the go

Mothers experience effortless expressing at the touch of a button. Simple settings make it easy for them to become accustomed to operation. The system can be plugged in, or used 'on the go' with 4 AA batteries. And the system is compatible with the full range of Philips Avent milk storage solutions.



## Pump mimics infant suckling behavior

By combining breast compression with gentle suction, the pump is designed to mimic the infant's suckling behavior. It features our clinically proven massage cushion with soft petals that gently compress the breast to stimulate milk flow. This innovative cushion has a distinctive, velvety texture that feels warm on the breast, further helping mothers to relax while expressing.





## Lightweight and easy-to-clean

The Philips Avent Comfort twin electric breast pump weighs less than 626g (22.08 oz) and delivers a vacuum strength of 33mbar. The tube wraps around the base unit for extra convenience. The system is a closed system for easy cleaning so breast milk can never get into the tubing or motor unit. All parts can be immersed in water and sterilized except for the electrical parts.



## User perceptions on the Comfort electric breast pump

In a recent study of UK mothers, 91% of mothers strongly agreed that being comfortable when expressing is important for good milk flow and 86% of mothers were very satisfied with the effectiveness of the breast pump, while 96% of mothers strongly agreed that this breast pump is easy to use\*

## More milk in less time

The Philips Avent twin breast pump has been clinically proven to deliver as much milk as a hospital grade pump. Healthcare professionals recommend it to mothers, particularly preterm mothers, for a comfortable and effective experience. The small size and unique comfort features enable practical and relaxing milk expression.

Pumping mode	Double electric
Vacuum levels	Stimulation mode: 128mmHg. Expression setting 1: 169mmHg Expression setting 2: 209mmHg. Expression setting 3: 250mmHg
What's in the pack	1x breast pump expression unit 2x breast pump expression unit (including 2x Philips Avent Natural bottle) 1x motor unit including tubing & connecting caps 2 x newborn flow teat 2x hygiene covers, 2x sealing discs for breast milk storage 1x power adapter 2x spare diaphragms 1x instruction manual for Comfort breast pump 1x instruction manual for Natural bottle 1x day breastpad sample pack 1x night breastpad sample pack 1x handy travel bag
Materials	Polypropylene: pump body, hygiene cover for funnel,Natural bottle. Silicone: cushion, diaphragm, valve, newbornflow teat TPE: sealing disc. Entirely BPA free
Dimensions	Expression unit: Total height: 17.1cm (when fully assembled) Expression unit: Total width: 13.5cm (when fully assembled) Motor unit: Total height: 10.5cm, Total width: 14.2cm, Totaldepth: 10.4cm
Weight	Expression unit: 125g (when fully assembled) Motor unit including tubing: 452g
Cleaning	All parts can be immersed in water and sterilised except forthe electrical parts
Assembly	Easy visual matching of parts. Few small pieces
Instructions of use	Printed instruction manual with easy-reference troubleshooting guide
Warranty	2 years

Accessories	Large soft massage cushion available for purchase separately.
Available spare parts	Pump body, massage cushion, massage cushion large Diaphragm and valve, tubing, power adapter, motor unit, Hygiene cover for cushion.hygiene cover for cushion, battery lidon motor unit

<sup>1</sup> The Philips Avent Comfort twin electric breast pump weighs less than 626g (22.08 oz) and delivers a vacuum strength of 33mbar. The tube wraps around the base unit for extra convenience. The system is a closed system for easy cleaning so breast milk can never get into the tubing or motor unit. All parts can be immersed in water and sterilized except for the electrical parts.

\* Independent home placement test among 76 mothers in the US, August 2012

<sup>3</sup>Jones, et al, A randomized controlled trial to compare methods of milk expression after preterm delivery, ADC 2001:85:F91

# Comfort Single Electric Breast Pump

Single breast expression

Designed for mothers' comfort, this small, portable single electric pump is convenient to use in or out of the home. Three user controlled vacuum settings offer personalized comfort for a steady supply of milk.



# Features



## 3 simple expression settings

When switched on, the pump automatically starts in a gentle stimulation mode to help trigger let down. Then the mother can choose between three 'one touch' pressure settings to make the milk flow most effectively for her. The system's comfort features have been clinically proven to lead to more milk expression.



## Easy-to-use, even on the go

Mothers experience effortless expressing at the touch of a button. Simple settings make it easy for them to become accustomed to operation. The system can be plugged in, or used 'on the go' with 4 AA batteries. And the system is compatible with the full range of Philips Avent milk storage solutions.



## Lightweight and easy-to-clean

The Philips Avent Comfort single electric breast pump weighs less than 393g (13.86 oz) and the tube wraps around the base unit for extra convenience. The system is a closed system for easy cleaning. Designed so breast milk doesn't get into the tubing or motor unit. All parts can be immersed in water and sterilized except for the electrical parts.



## Pump mimics infant suckling behavior

By combining breast compression with gentle suction, the pump is designed to mimic the infant's suckling behavior. It features our clinically proven massage cushion with soft petals that gently compress the breast to stimulate milk flow. This innovative cushion has a distinctive, velvety texture that feels warm on the breast, further helping mothers to relax while expressing.



## User perceptions on the Comfort electric breast pump

In a recent study of UK mothers, 91% of mothers strongly agreed that being comfortable when expressing is important for good milk flow and 86% of mothers were very satisfied with the effectiveness of the breast pump, while 96% of mothers strongly agreed that this breast pump is easy to use\*

## For a constant supply

Recommended by healthcare professionals for its small size and unique features, the Philips Avent Comfort single electric breast pump is clinically proven to deliver as much milk as a leading competitor breast pump but with significantly more comfort. It is ideally positioned for use in the home where a steady supply of breast milk is required.

# Specifications

## Single Electric Breast Pump Specifications

---



Pumping mode	Single electric
Vacuum levels	Stimulation mode: 128mmHg. Expression setting 1: 169mmHg Expression setting 2: 209mmHg. Expression setting 3: 250mmHg
What's in the pack	1x breast pump expression unit (including 1x Philips Avent Natural bottle) 1x motor unit including tubing & connecting cap 1x newborn flow teat 1x hygiene cover for cushion 1x sealing disc for breast milk storage 1x power adapter 1x spare diaphragm 1x instruction manual for Comfort breast pump 1x instruction manual for Natural bottle 1x day breastpad sample pack 1x night breastpad sample pack
Materials	Polypropylene: pump body, hygiene cover for funnel,Natural bottle. Silicone: cushion, diaphragm, valve,newborn flow teat TPE: sealing disc Entirely BPA free
Dimensions	Expression unit: Total height: 17.1cm (when fully assembled) Expression unit: Total width: 13.5cm (when fully assembled) Motor unit: Total height: 6.8cm, Total width: 14.2cm, Totaldepth: 10.4cm
Weight	Expression unit: 125g (when fully assembled Motor unit including tubing: 307g
Cleaning	All parts can be immersed in water and sterilised except forthe electrical parts
Assembly	Easy visual matching of parts. Few small pieces
Instructions of use	Printed instruction manual with easy-referencetroubleshooting guide
Warrantv	2 years

---

Available spare parts	Pump body, massage cushion, massage cushion large
	Diaphragm and valve, tubing, power adapter, motor unit
	Hygiene cover for cushion, battery lid on motor unit

---

\* Independent home placement test among 85 mothers in the UK, August 2012

# Comfort Manual Breast Pump

Breast Pump for manual use

This manual breast pump with compact design, wide neck, and ergonomic shape helps mothers fulfill their breastfeeding needs. Now it's easy to travel, pump, store, and feed.



# Features



## Unique, natural expressing position

This manual breast pump has a unique compact breast shield design and a short angled funnel. Mothers can sit in a comfortable position when expressing. Unlike other breast pumps, mothers can sit in a relaxed, upright position when expressing, while milk flows directly into the container.



## Ergonomic shape for fingertip control

The Comfort manual breast pump is compact with an ergonomically shaped handle for effortless fingertip control. This allows mothers to keep a tight seal on the breast, making pumping easier. The vacuum level is easily controlled by one hand.



## Pump mimics infant suckling behavior

By combining breast compression with gentle suction, the pump is designed to mimic the infant's suckling behavior. It features our clinically proven massage cushion with soft petals that gently compress the breast to stimulate milk flow. This innovative cushion has a distinctive, velvety texture that feels warm on the breast, further helping mothers to relax while expressing.



## Pump, store, feed all in one

The Comfort manual breast pump is portable, small and lightweight. And it fits the full range of Philips Avent milk storage solutions. The recognized ease of use and the low cost of this pump reduces the barriers to milk expression, making it an ideal way for busy mothers to achieve their infant feeding goals.



## User perceptions on the Avent manual pump

In a recent study of UK mothers, 94% mothers strongly agreed that being comfortable when expressing is important for good milk flow while 90% of mothers were very satisfied with the effectiveness of the breast pump and 97% of mothers strongly agreed that the Philips Avent Manual pump is easy to use\*

## A practical feeding solution

For healthcare professionals, Philips Avent Comfort manual breast pump is an ideal solution to initiate and maintain a breast milk supply for mothers of term and pre-term infants. With a clinically proven ergonomic design and gentle massage cushion, this breast pump is the #1 brand recommended by moms worldwide<sup>1</sup>.

# Niplette™

Self-help solution for flat or inverted nipples

For mothers experiencing difficulties in breastfeeding due to flat or inverted nipples, the Niplette pulls the nipple out into a thimble-like cup, stretching the lactiferous ducts over time.





# Features



## Gentle sucking action

The revolutionary Niplette makes it possible for women with flat or inverted nipples to comfortably breastfeed. Through gentle suction, the Niplette pulls the nipple out into a small plastic thimble-like cup. A permanent correction is normally achieved in between one and three months of continuous use.



## Clinically proven success

In a study at Queen Mary's University, Roehampton, London, 22 female patients who were considered for surgical treatment (duct divisions) for their inverted nipples were fitted with the Niplette. In every case, the Niplette effectively corrected inverted nipples (even in those patients with deeply inverted nipples) without the need for invasive surgery\*.



## Ideal for use before pregnancy

Ideally the Nipplette should be used before pregnancy. Alternatively, mothers can use the Nipplette for a few minutes before each feed in the first few days after delivery. This will pull the nipple out so the baby can latch on more easily.

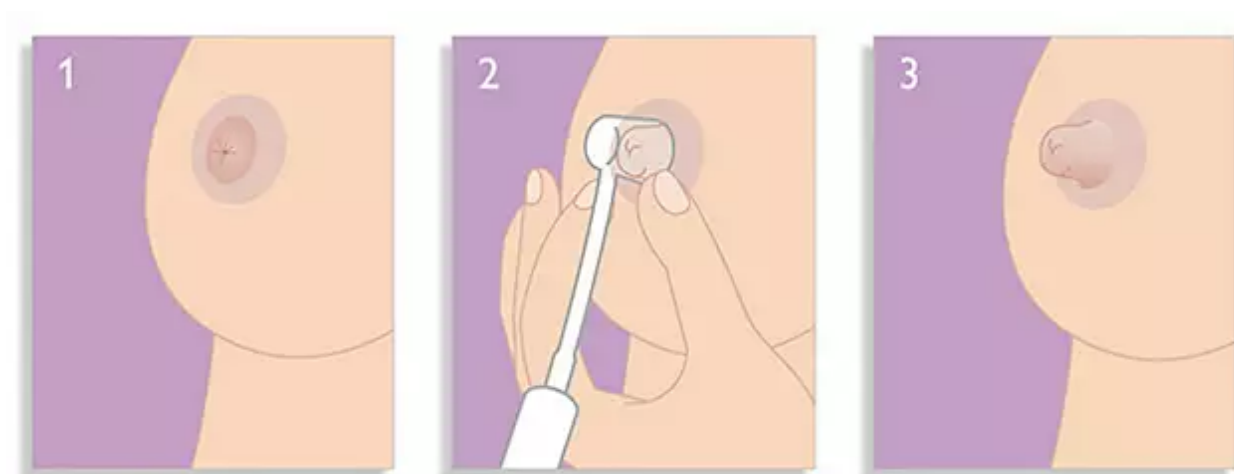

## Simple procedure

The cup is held over the nipple areola and air is withdrawn using a 5 ml syringe so that the nipple can be sucked into it. The patient controls the pull and they are instructed to pull on the nipple as firmly as comfortable. Initial usage is encouraged as much as possible. Ideally, the Nipplette should be worn in 8-hour periods (day and night)\*.

## Simple, painless flat nipple solution

Inverted or non-protractile nipples affect up to 10% of women, making initiation and establishment of breastfeeding difficult for both mother and baby. The suckling action of the baby should draw out the nipple. If not, the Nipplette™ is a simple, painless solution that can help.

# Comfort Breast Shells

Ultra-soft shells for nipple protection

These ultra-soft breast shells are worn inside a nursing mother's bra to protect her nipples from chafing and prevent breast milk leakage.



# Features



## Protects sore or cracked nipples

Philips Avent 'ventilated' shells are worn inside the bra to protect sore or cracked nipples from chafing, while allowing air to circulate. This helps nipples heal more quickly. The gentle pressure can also help ease engorgement. These shells are not made with BPA, DEHP, or natural rubber latex.



## Collects leaking breast milk

When mothers are feeding or expressing, the Philips Avent breast milk collection shells (no ventilation holes) can be used to collect leaking breast milk. Include in your professional advice to mothers that only milk collected using sanitized breast milk collection shells should be stored for later use.



## Easy to use

A Philips Avent Comfort Breast Shell consists of two parts – the shell (either ventilated or breast milk collection shell) and the ultra-soft backing cushion. The soft silicone back cushion lies against the mother's breast and the polypropylene shell simply snaps over top. Remember to recommend to mothers that breast shells be worn for a maximum of 40 minutes at a time so they do not cause undue pressure on milk ducts.

# Nipple Protectors

Ultra-thin silicone nipple protectors

Give nursing mothers relief from sore or cracked nipples with these soft, ultra-thin, odorless, medical grade silicone nipple protectors.



# Features

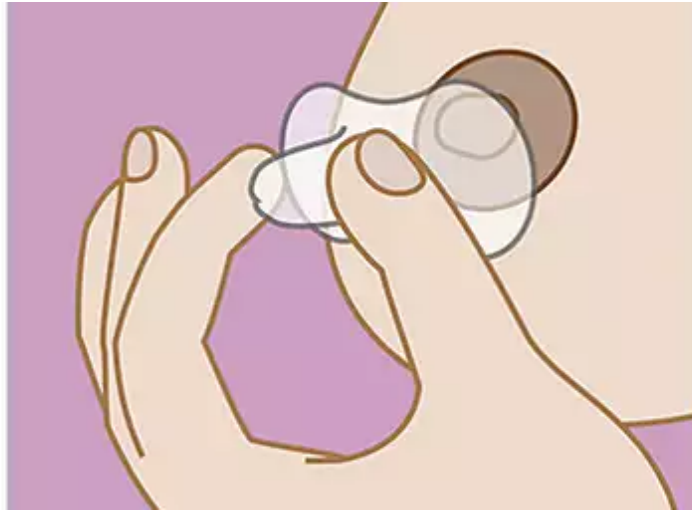

## Sore nipple protection

Philips Avent nipple protectors are made of soft, ultra-thin, odorless, medical grade silicone. They are designed for use by nursing mothers who have developed sore or cracked nipples and are not manufactured with BPA, DEHP, or natural rubber latex. They should only be considered upon advice from a healthcare professional such as you.



## Shaped for maximum skin contact

Philips Avent nipple protectors are butterfly shaped to allow baby more contact with the breast and not interfere with natural mother/baby bonding. Baby can still feel and smell the mother's skin and continue to stimulate the milk supply while suckling, returning easily to the breast once nipples are healed.





## Designed to fit

Designed with 3 holes for optimum milk flow to baby. Available in two sizes, standard and small. The small size is ideal for use by smaller babies since the smaller circumference of the nipple section makes it easier for them to latch on.

# Breast Milk Storage Bags

Healthy storage of breast milk

Convenient, pre-sterilized, one-time use bags provide safe and secure storage for a nursing mother's precious breast milk.



# Features



## Convenient single-use design

Nursing mothers get exceptional protection for their breast milk with the Philips Avent breast milk storage bags. Each (180ml/6oz) pre-sterilized bag comes ready for immediate use and can be stored in the refrigerator or freezer. A great recommendation from professionals such as you.



## Safe, secure storage

Each bag is easy-to-use with a wide opening for quick filling and pouring. You can feel confident about a mother's storage of her breast milk with these bags. It's easy for them to follow proper storage guidelines for maximum safety. Tamper evident seal for complete hygiene, reinforced seams and dual layer bag and secure, leak-proof double zipper.

# Natural bottles

## Natural bottle

The Natural bottle's breast shaped nipple promotes natural latch-on, making it easy to combine with breastfeeding. Petals inside the nipple increase softness and flexibility without nipple collapse.



# Features



## The natural way to bottle feed

Our Natural bottles have been designed to respond to the infant's natural suckling behavior as accurately as possible. Ultrasound studies of infant feeding have informed the design of the nipple. A small hole size delivers a more controlled flow rate and the soft, texture more closely resembles the breast.



## Natural latch on

A specially designed breast shaped nipple promotes easy latch on, helping nursing mothers to more easily combine breast and bottle-feeding. Its natural shape provides infants with an intuitive feeding experience that is as close to breastfeeding as possible.



## Exclusive comfort petals

The innovative nipple incorporates extra soft comfort petals to give it added flexibility without nipple collapse, allowing for an uninterrupted milk flow, as long as the baby is actively suckling.



## Innovative valve design

An innovative twin valve design reduces colic and discomfort. The microscopic valves vent air into the bottle preventing vacuum build up during the feed, which can lead to interruptions in the feed, air ingestion and colic.



## Easy-to-use, easy-to-clean

The Natural feeding bottle has just a few parts for quick and easy assembly. There are clear markings to ensure accurate measurement and make it easier to determine how much milk the baby has been fed. The unique shape is easy to hold and grip in any direction for maximum comfort. And the wide neck makes filling, cleaning, and sterilization easy.



## Our Natural range

The Natural bottles are available in a variety of bottle and nipple sizes depending on infant needs. Plastic bottles in four sizes from 60ml/2oz to 330ml/11oz. Glass bottles in two sizes, 120ml/4oz and 240ml/8oz. Nipples come with 1 to 4 holes, and a slot cut or Y-slot cut option. All infant feeding bottles are compatible with Philips Avent breast pumps.





## User perceptions on the Natural nipple

In a recent study of UK with mothers and their babies, 9 out of 10 babies accepted Natural nipple easily and 8 out of 10 mothers say that their baby was content to drink from the Natural nipple. The study also found that 9 out of 10 mothers agreed that the bottle was also easy to hold.\* In a separate clinical trial, natural bottles scored significantly higher on ease-of-cleaning, shape of the nipple, leakage, and overall performance.\*\*

# Anti-colic bottles

## Anti-colic infant feeding bottle

The clinically proven design of the Anti-colic bottle helps to reduce colic and discomfort\*. Its easy latch on nipple and ergonomic shape provides a comfortable feeding experience for baby and mother.



# Features



## Unique anti-colic system

Since 1984 we have been working with leading scientists and healthcare professionals like you to perfect an anti-colic bottle. Clinical studies show that as baby feeds, the unique skirt on the Anti-colic bottle nipple allows air into the bottle instead of baby's stomach.



## More comfort for a more enjoyable feed

The innovative valve built inside the nipple offers easy latch on and flexes to baby's feeding rhythm. Milk flows only at the pace chosen by the baby to minimize overeating, spit-up, burping, and gas. The bottle also has an anti-leak system for a truly enjoyable feeding experience.



Clinically proven to reduce fussing<sup>2</sup> and discomfort<sup>1</sup>

A randomized clinical trial was carried out to see whether an infant baby bottle design affects "infant behavior". The Philips Avent Anti-colic bottle was shown to significantly reduce fussing by approximately 28 minutes a day as compared to the comparator bottle (46 min vs. 74 min,  $p=0.05$ ) This was especially true during nighttime<sup>3 4</sup>.



Ergonomic shape for easy holding

Philips Avent Anti-colic bottle infant colic bottles are ergonomically shaped for maximum comfort. They are easy to hold and grip from any direction, even for baby's tiny hands.

Bottle	Material: BPA free*
Design	Bottle design: Ergonomic shape, Wide neck
Development stages	Stages: 0-12 months
Ease of use	Bottle use: Easy to clean, Easy to hold  Ease of use: Dishwasher & microwave safe, 5 parts
Functions	Latch on: Easy latch on, Promotes nipple acceptance  Nipple: Two piece anti-colic system, Flexes to feeding rhythm
Material	Bottle: BPA free*, Polypropylene  Nipple: BPA free*, Soft silicone
What is included	Baby Bottle: 3 pcs
Compatibility	Compatible with: Breast Pump, Milk storage cups and Anti-colic Nipples

<sup>1</sup> A clinical study showed that at 2 weeks of age, infants fed with an Philips Avent bottle showed less colic than infants fed with another leading bottle

<sup>2</sup> Babies fed with Philips Avent Airflex bottles fussed 60% less than those fed with a leading competitor's anti-colic vented bottle

<sup>3</sup> Lucas et al. 105th Ross Conf. Pediatric Res. 1997. At 2 weeks of age, babies fed with a Philips Avent bottle showed a trend to less colic than babies fed with a conventional bottle.

<sup>4</sup> Fewtrell et al. BMC Research Notes 2012, 5:150 At 2 weeks of age, babies fed with a Philips Avent bottle showed a significant reduction in fussing compared to babies fed with another leading bottle.

<sup>5</sup> "Colic, Crying, Fussing and Feeding," Clinical trial summary, PHI8008-CTF\_Bottle\_Colic\_trial\_LR.pdf Fewtrell et al. 2012.....

\*Our anti-colic bottle's Airflex venting system and textured nipple is designed to minimize feeding interruptions and discomfort. With its integrated anti-colic valve, air is vented into the bottle and away from the baby's tummy.

# Premium Bottle Warmer

Warms gently and evenly to preserve nutrients and vitamins

This premium bottle warmer circulates breast milk as it heats, warming the milk gently and evenly, and avoiding hot spots. Auto temperature controls indicate progress and shut unit off to prevent overheating.



# Features



## Gentle, even warming

Parents must warm breast milk in a safe and controlled way to preserve nutrients and vitamins in breast milk. The Philips Avent premium bottle warmer uses a water bath technology, rather than steam, to warm breast milk gently and evenly. The milk circulates as it heats, preventing hot spots from occurring.



## Auto controls for safe temperature

An integrated sensor constantly tracks and controls the milk temperature to avoid overheating, so it reaches and stays at the perfect end temperature for the baby to drink. The automatic 'keep warm' setting keeps milk warm for 20 minutes before shutting off.



## Easy to use

Parents will place the bottle in the warmer – then fill it with the same amount of water as milk. They'll choose a setting and switch the warmer on. When the indicator lights up continuously, the milk will have reached the proper temperature. There is also a convenient defrost setting to defrost frozen breast milk.



# Specifications

## Specifications

Milk and food warming	SCF356 - Yes
Compatible with all Philips Avent bottles and containers**	SCF356 - Yes
Speed of warming	SCF356 - about 10 min (3oz at room temperature)
Different end temperatures based on your need	SCF356 - Yes
Defrost function	SCF356 - Yes
Always safe milk temperatures	SCF356 - Yes
Keep warm function	SCF356 - Yes
Automatic shut-off	SCF356 - Yes
Progress indicator visual alert when food is ready	SCF356 - Yes

# 3-in-1 Electric Steam Sterilizer

Electric sterilizer

The adjustable 3-in-1 electric sterilizer uses natural steam to kill 99.9% of harmful germs in just 6 minutes and can keep 6 full-size bottles sterile for up to 24 hours at a time.



# Features



## Modular, space saving design

The modular 3-in-1 design adjusts to users preferences and requires minimal counter space. Bottles and accessories can be easily organized and loaded, whether it's just a few small items or a full load.



## Fast, natural steam sterilization

Parents should be informed of the importance of sterilization. The Philips Avent 3-in-1 electric steam sterilizer uses natural steam to kill 99.9% of harmful germs in just 6 minutes and keeps the contents sterile for up to 24 hours (if the lid is unopened). When the sterilizing cycle ends, the unit has an automatic shut-off.



## Large capacity

The sterilizer's spacious interior holds up to six 330ml/11oz Philips Avent Classic or Natural Bottles at once. It can also be filled with various breast pumps and accessories or other standard baby bottles.



## Easy to clean

With its open design, the sterilizer can be quickly disassembled to easily clean the heating plate, allowing for clean steam sterilization every time.

Country of origin	Made in: Turkey
What is included	Electric steam sterilizer: 1 piece Tongs: 1 pcs
Power	Voltage: 110 V
Development stages	Stages: 0 - 6 months
Material	Polypropylene
Weight and dimensions	Dimensions: 290 x 160 x 350 (w x d x h) mm Weight: 1.5 kg
Compatibility	Philips-Avent range compatible

# Soothie Shapes

One piece pacifier

Soothie Shapes is a one-piece silicone pacifier with a bear shaped design suitable for newborns up to 3 months of age. The flexible shield is soft and comfortable against baby's delicate skin.



# Features



## One lightweight piece

Philips Avent 'soothies' have been used for year in the hospital setting. Now the Soothie Bear can be recommended for home use. Parents with newborns up to 3 months find its one-piece silicone construction very lightweight and easy to handle. The simple but durable bear-shaped design won't become misshapen over time.



## Flexible, comfortable, easy to clean

The soft, flexible shield fits comfortably to baby's face. Small holes on the shield create extra airflow to prevent skin irritation. Soothie Bear can be easily sterilized and is dishwasher safe. Because the silicone is transparent, it is easy to see the dirt and know when it's time to clean it.



## Medical grade silicone

Soothie Bears are made from a very strong, high-quality, medical grade silicone and are not manufactured with BPA, DEHP, or natural rubber latex. Quality controls are put in place to ensure clean manufacturing conditions. Silicone is far more durable than latex in hot water, and is more suitable for dishwasher and sterilizer use.

## Orthodontic nipple

The orthodontic nipple is designed to be taste and odor free so it is more likely to be accepted by baby. It is also tested for bite and tear resistance.



# Specifications

## Soothie Bear Specifications

Country of origin	USA
What is included	Silicone Pacifier: 2 pcs
Features	Can be sterilized
	BPA-Free
	Helps to comfort your baby
	Medical grade silicone
	One-piece construction
Development stages	Stages: 0 - 3 months

# Mini Orthodontic Pacifier

Newborn pacifier

Developed for tiny babies, this small pacifier fits newborns perfectly. Its plastic/silicone construction, lightweight shield, and security ring handle make it the logical choice for newborns and babies to 2 months.

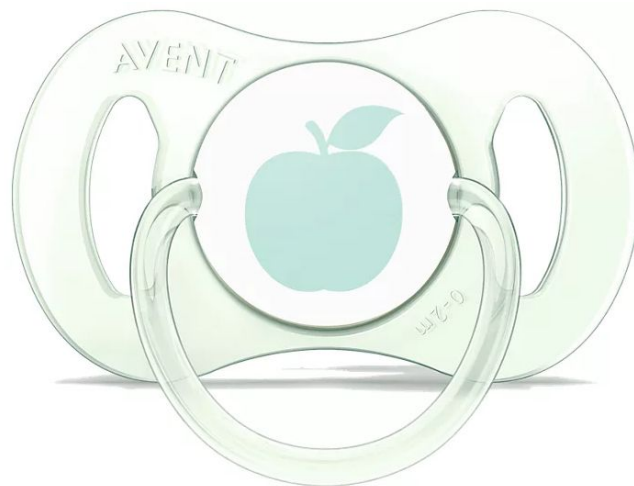

# Features



## Designed for the youngest

An exceptional bridge from hospital to home, this soother fits the newborn mouth perfectly, without touching the nose. To support an infant's innate nonnutritive sucking response, it can be introduced at the earliest stages, and used through two months of age.



## Tiny, lightweight, and strong

The Mini Orthodontic Pacifier is the smallest pacifier of the Philips Avent line that you can recommend to parents. The lightweight shield with airflow holes keeps a newborn's delicate skin cool. A security ring handle allows for quick removal at any time. Simple, rugged construction means it is dishwasher and sterilizer safe.



## Medical grade silicone

Nipples for the Mini Orthodontic Pacifiers are made from a very strong, high-quality, medical grade silicone and not manufactured with BPA, DEHP, or natural rubber latex. Quality controls are put in place to ensure clean manufacturing conditions. Silicone is far more durable than latex in hot water, and is more suitable for dishwasher and sterilizer use.



## Orthodontic nipple

The orthodontic nipple is flat, symmetrical and drop-shaped, so even if the pacifier ends upside down in the mouth there is no ill effect. The nipple is designed to be taste and odor free so it is more likely to be accepted by baby.

Country of origin	England
What is included	Silicone Pacifier: 2 pcs Snap-on hygienic cap: 2 pcs
Features	Can be sterilized BPA-Free Helps to comfort your baby Hygienic cap
Development stages	Stages: 0-2 months

**По вопросам продаж и поддержки обращайтесь:**

Алматы (7273)495-231  
Ангарск (3955)60-70-56  
Архангельск (8182)63-90-72  
Астрахань (8512)99-46-04  
Барнаул (3852)73-04-60  
Белгород (4722)40-23-64  
Благовещенск (4162)22-76-07  
Брянск (4832)59-03-52  
Владивосток (423)249-28-31  
Владикавказ (8672)28-90-48  
Владимир (4922)49-43-18  
Волгоград (844)278-03-48  
Вологда (8172)26-41-59  
Воронеж (473)204-51-73  
Екатеринбург (343)384-55-89  
Иваново (4932)77-34-06  
Ижевск (3412)26-03-58  
Иркутск (395)279-98-46  
Казань (843)206-01-48  
Россия +7(495)268-04-70

Калининград (4012)72-03-81  
Калуга (4842)92-23-67  
Кемерово (3842)65-04-62  
Киров (8332)68-02-04  
Коломна (4966)23-41-49  
Кострома (4942)77-07-48  
Краснодар (861)203-40-90  
Красноярск (391)204-63-61  
Курск (4712)77-13-04  
Курган (3522)50-90-47  
Липецк (4742)52-20-81  
Магнитогорск (3519)55-03-13  
Москва (495)268-04-70  
Мурманск (8152)59-64-93  
Набережные Челны (8552)20-53-41  
Нижний Новгород (831)429-08-12  
Новокузнецк (3843)20-46-81  
Ноябрьск (3496)41-32-12  
Новосибирск (383)227-86-73  
Киргизия +996(312)-96-26-47

Омск (3812)21-46-40  
Орел (4862)44-53-42  
Оренбург (3532)37-68-04  
Пенза (8412)22-31-16  
Петрозаводск (8142)55-98-37  
Псков (8112)59-10-37  
Пермь (342)205-81-47  
Ростов-на-Дону (863)308-18-15  
Рязань (4912)46-61-64  
Самара (846)206-03-16  
Саранск (8342)22-96-24  
Санкт-Петербург (812)309-46-40  
Саратов (845)249-38-78  
Севастополь (8692)22-31-93  
Симферополь (3652)67-13-56  
Смоленск (4812)29-41-54  
Сочи (862)225-72-31  
Ставрополь (8652)20-65-13  
Сургут (3462)77-98-35  
Казахстан +7(7172)727-132

Сыктывкар (8212)25-95-17  
Тамбов (4752)50-40-97  
Тверь (4822)63-31-35  
Тольятти (8482)63-91-07  
Томск (3822)98-41-53  
Тула (4872)33-79-87  
Тюмень (3452)66-21-18  
Ульяновск (8422)24-23-59  
Улан-Удэ (3012)59-97-51  
Уфа (347)229-48-12  
Хабаровск (4212)92-98-04  
Чебоксары (8352)28-53-07  
Челябинск (351)202-03-61  
Череповец (8202)49-02-64  
Чита (3022)38-34-83  
Якутск (4112)23-90-97  
Ярославль (4852)69-52-93